

Connecting to CTE LG Displays

Right Click on your desktop area and choose Display Settings...

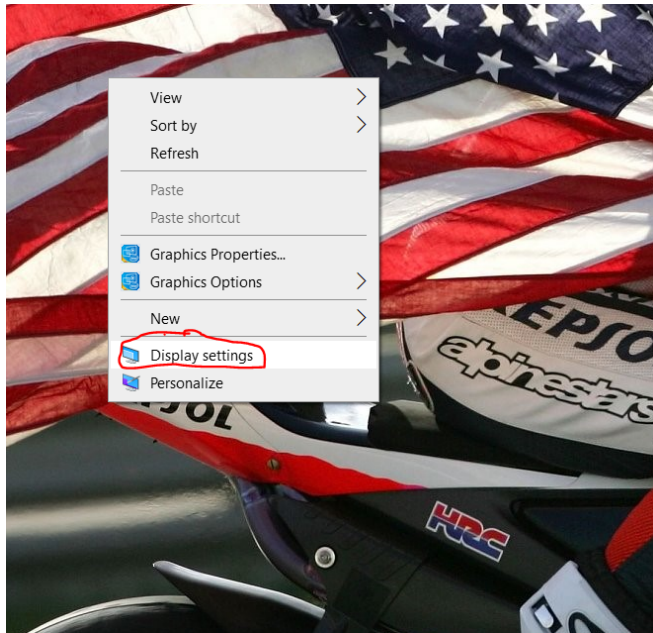

On Display Settings scroll down to the Multiple Displays area and choose “Connect to a Wireless Display”...

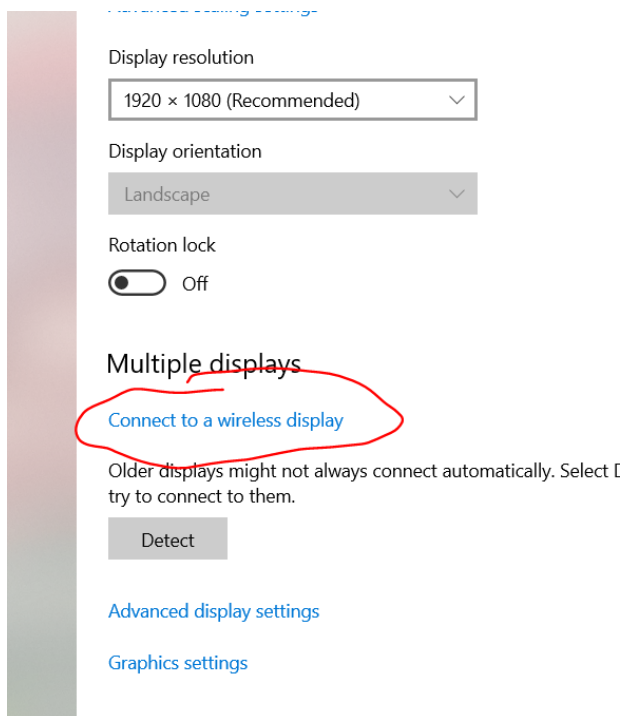

This will pop up a box to the right of your screen. You should see the TV with the name Room # and the number for your room.

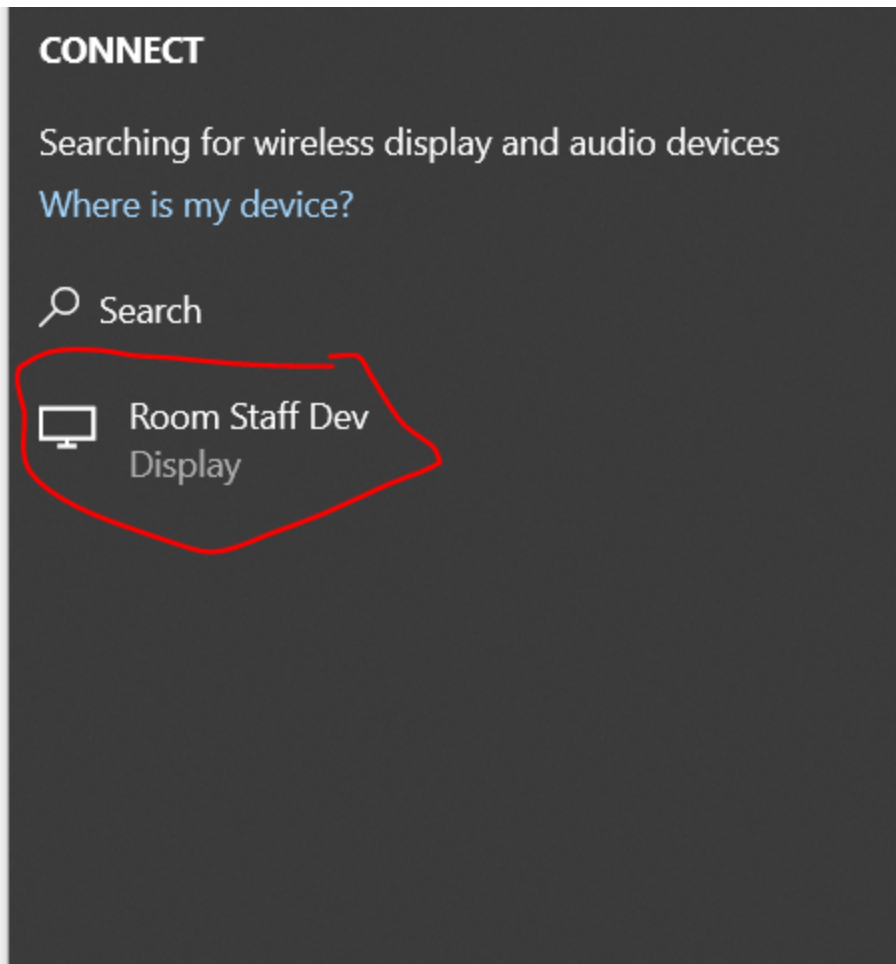

Click on that and it will initiate the connection to your display. If this is the first time you have connected to it, you will see a pop up on the Television with your computer name and it asking if you want to allow connection. Use the remote and make sure Yes is highlighted and hit OK.

Once done you should be connected to the display. Under the Multiple Display settings you can choose if you want to have Duplicate Displays or Extendend Displays.

Once done you can click Disconnect on the top of your desktop where it shows the connection status for the wireless display.

Once you connect a second time you should not have to do anything on the Display with the remote, but you will need to go through this process each time you want to connect to the display.

Sound and video both run through the Television.